



# SUNNICA ENERGY FARM

EN010106

8.48 Tree Preservation Order Location Plan

Planning Act 2008

Infrastructure Planning (Examination Procedure) Rules 2010



Planning Act 2008

**Infrastructure Planning  
(Examination Procedure) Rules 2010**

## **Sunnica Energy Farm**

### **8.48 Tree Preservation Order Trees Location Plan**

<b>Planning Inspectorate Scheme Reference</b>	EN010106
<b>Application Document Reference</b>	EN010106/APP/4.48
<b>Author</b>	Sunnica Energy Farm Project Team

<b>Version</b>	<b>Date</b>	<b>Status of Version</b>
Rev 00	22 November 2022	Submitted at Deadline 3
Rev 01	13 January 2023	Submitted at Deadline 5

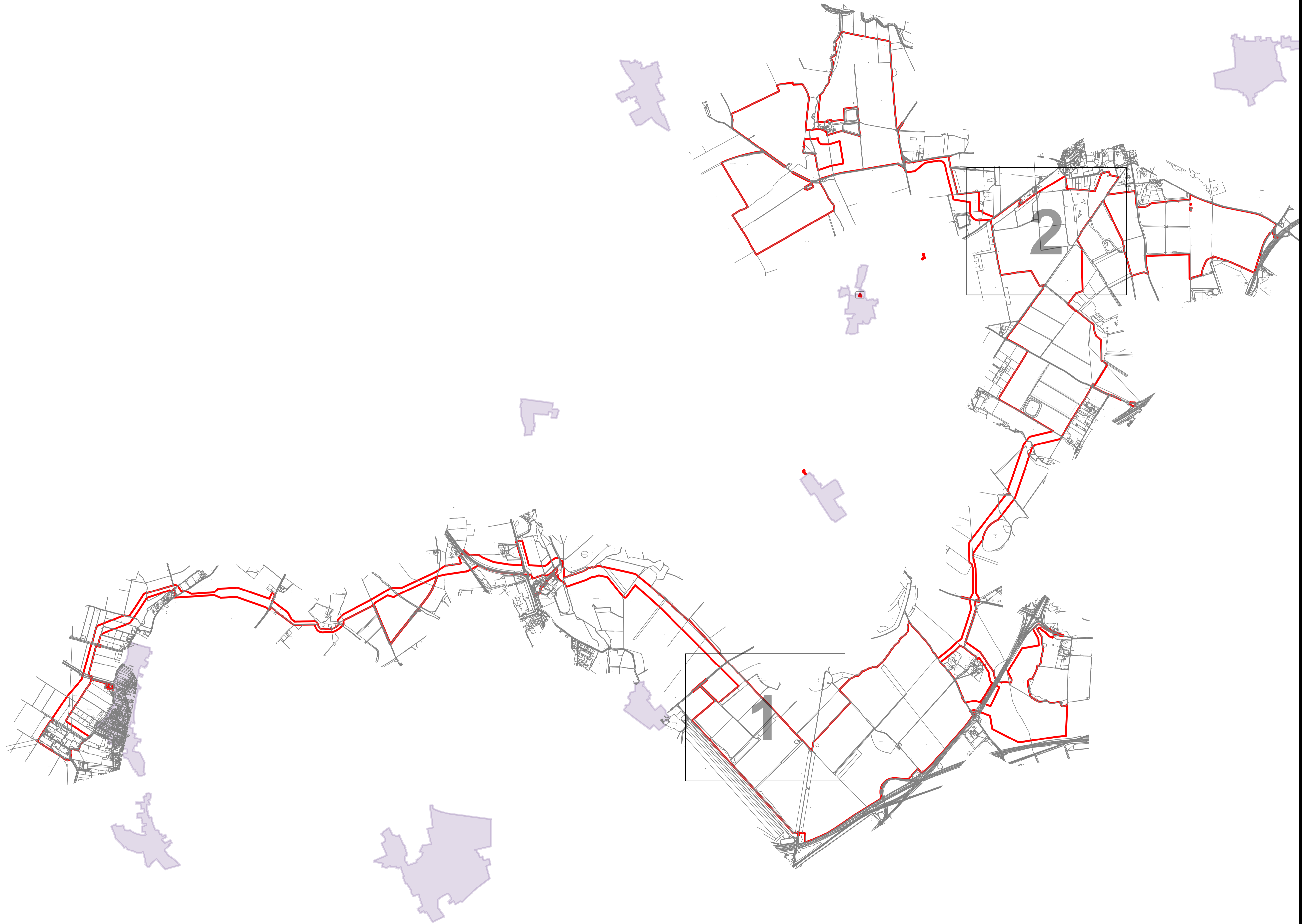

**PROJECT**  
 SUNNICA ENERGY FARM

**CLIENT**  
 SUNNICA ENERGY FARM

**CONSULTANT**  
 AECOM  
 Plumer House, Third Floor,  
 East Wing, Tallyour Road  
 Plymouth, PL6 5DH  
 Tel +44(0)1752 676700  
 Fax +44(0)870 238 6023  
 www.aecom.com

**GENERAL NOTES**

- TREE LOCATIONS ARE BASED ON THE TOPOGRAPHICAL SURVEY, AERIAL IMAGERY, AND GPS CO-ORDINATES FROM ON SITE WALKOVER.
- PLANS SHOULD BE READ IN CONJUNCTION WITH THE AECOM ARBORICULTURAL REPORT.
- DRAWING REFERENCES:  
 ref: 0481810.dwg  
 Sunnica\_RLB\_WP\_20221213.dwg

**KEY PLAN**

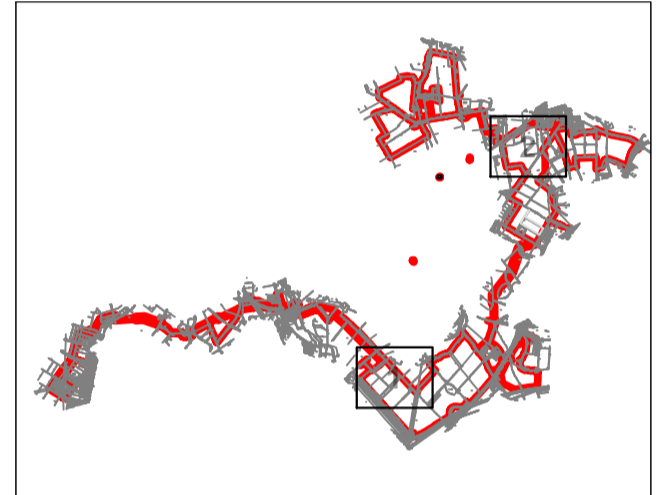

**KEY**

- ORDER LIMITS BOUNDARY
- TPO TREE FEATURE TO BE RETAINED AND PRUNED
- TPO TREE FEATURE TO BE REMOVED
- CONSERVATION AREA

**ISSUE/REVISION**

IR	DATE	DESCRIPTION
P01	13/01/23	SECOND ISSUE
00	22/11/22	FIRST ISSUE

**DRAWING STATUS**  
 SUBMITTED AT DEADLINE 5

**PROJECT NUMBER**  
 60589004

**SHEET TITLE**  
 TREE PRESERVATION ORDER  
 TREES LOCATION PLAN  
 (SHEET 0)

**SHEET NUMBER**      **REV.**  
 60589004-ACM-XX-XX-AB-TPOTLP-00    P01

This drawing has been prepared for the use of AECOM's client. It may not be used, modified, reproduced or relied upon by third parties, except as agreed by AECOM or as required by law. AECOM accepts no responsibility and denies any liability whatsoever to any party that uses or relies on this drawing without AECOM's express written consent. Do not scale this document. All measurements must be obtained from the scaled dimensions.

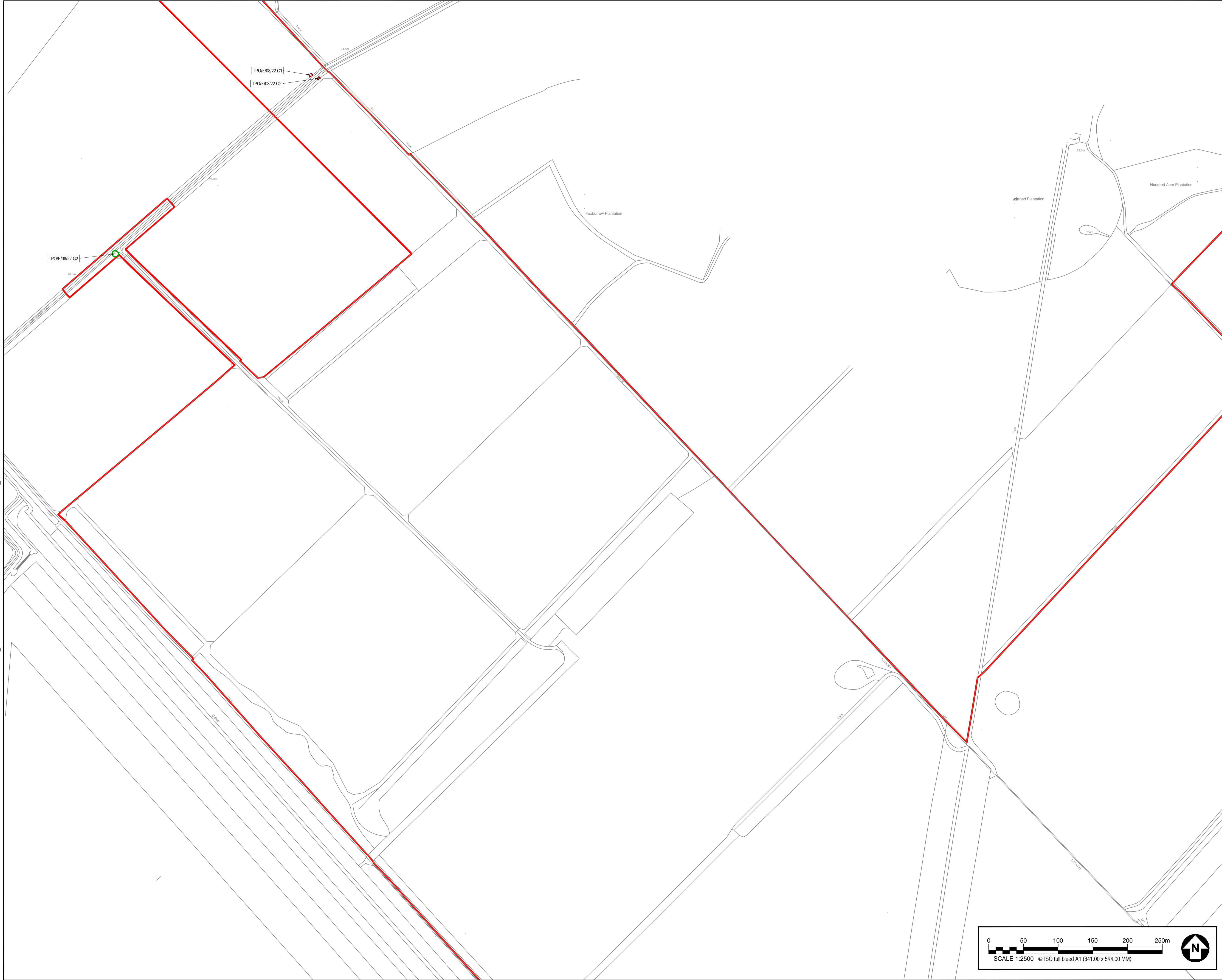

**PROJECT**  
 SUNNICA ENERGY FARM

**CLIENT**  
 SUNNICA ENERGY FARM

**CONSULTANT**  
**AECOM**  
 Plumer House, Third Floor,  
 East Wing, Tallyour Road  
 Plymouth, PL6 5DH  
 Tel +44(0)1752 676700  
 Fax +44(0)870 238 6023  
 www.aecom.com

**GENERAL NOTES**

1. TREE LOCATIONS ARE BASED ON THE TOPOGRAPHICAL SURVEY, AERIAL IMAGERY, AND GPS CO-ORDINATES FROM ON SITE WALKOVER.
2. PLANS SHOULD BE READ IN CONJUNCTION WITH THE AECOM ARBORICULTURAL REPORT.
3. DRAWING REFERENCES:  
 ref: labstr0.dwg  
 Sunnica\_RLB\_WIP\_20221213.dwg

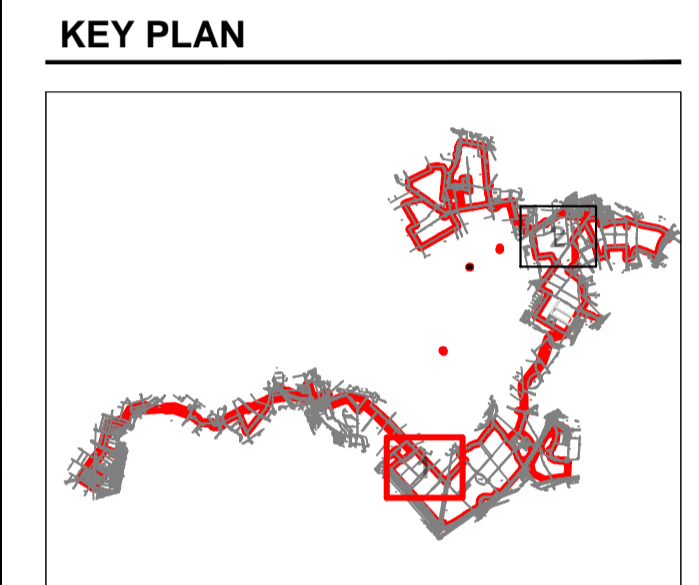

**KEY**

- ORDER LIMITS BOUNDARY
- TPO TREE FEATURE TO BE RETAINED AND PRUNED
- TPO TREE FEATURE TO BE REMOVED
- CONSERVATION AREA

**ISSUE/REVISION**

NO	DATE	DESCRIPTION
P01	13/01/23	SECOND ISSUE
00	22/11/22	FIRST ISSUE
VR		

**DRAWING STATUS**  
 SUBMITTED AT DEADLINE 5

**PROJECT NUMBER**  
 60589004

**SHEET TITLE**  
 TREE PRESERVATION ORDER  
 TREES LOCATION PLAN  
 (SHEET 1)

**SHEET NUMBER**      **REV.**  
 60589004-ACM-XX-XX-AB-TPOTLP-01    P01

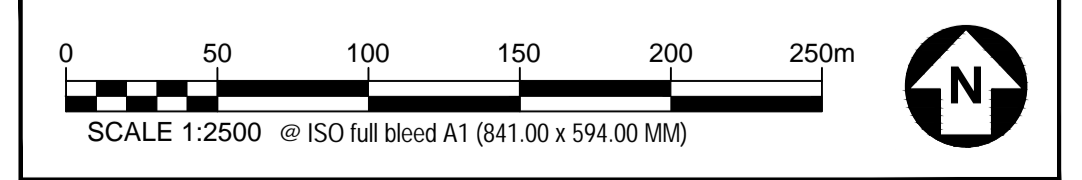

This drawing has been prepared for the use of AECOM's client. It may not be used, modified, reproduced or relied upon by third parties, except as agreed by AECOM or as required by law. AECOM accepts no responsibility and denies any liability whatsoever to any party that uses or relies on this drawing without AECOM's express written consent. Do not scale this document. All measurements must be obtained from the stated dimensions.



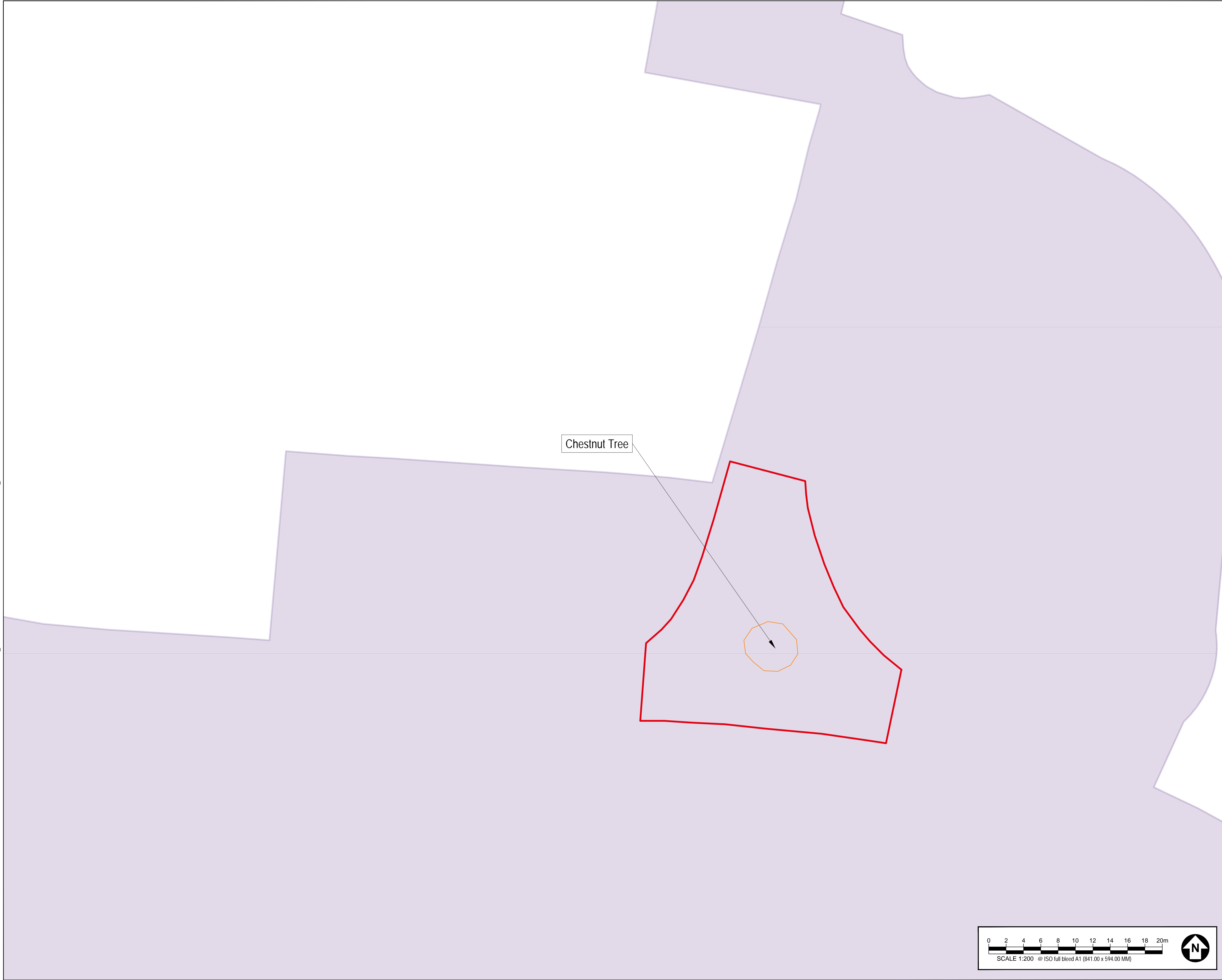

**PROJECT**  
SUNNICA ENERGY FARM

**CLIENT**  
SUNNICA ENERGY FARM

**CONSULTANT**  
**AECOM**  
Plumer House, Third Floor,  
East Wing, Tallyour Road  
Plymouth, PL6 5DH  
Tel +44(0)1752 676700  
Fax +44(0)870 238 6023  
www.aecom.com

**GENERAL NOTES**  
1. TREE LOCATIONS ARE BASED ON THE TOPOGRAPHICAL SURVEY,  
AERIAL IMAGERY, AND GPS CO-ORDINATES FROM ON SITE WALKOVER.  
2. PLANS SHOULD BE READ IN CONJUNCTION WITH THE AECOM  
ARBORICULTURAL REPORT.  
3. DRAWING REFERENCES:  
ref: 0481810.dwg  
Sunnica\_RLB\_WIP\_20221213.dwg

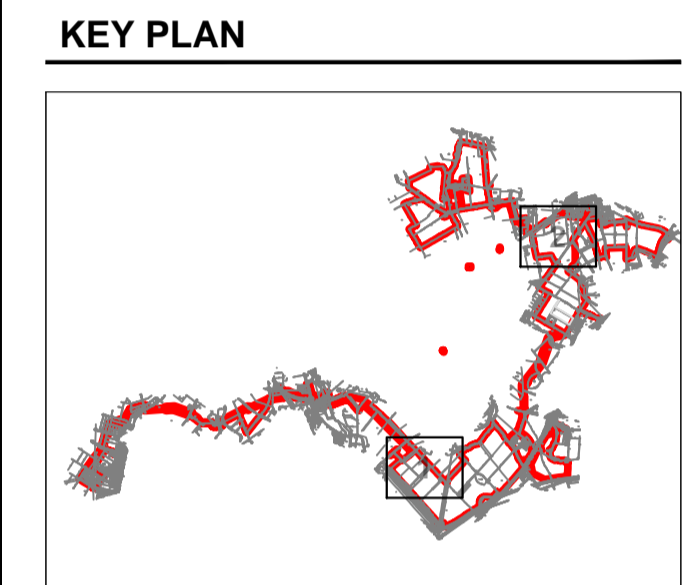

**KEY**

- ORDER LIMITS BOUNDARY
- TPO TREE FEATURE TO BE RETAINED AND PRUNED
- TPO TREE FEATURE TO BE REMOVED
- CONSERVATION AREA

**ISSUE/REVISION**

IR	DATE	DESCRIPTION
P01	13/01/23	SECOND ISSUE
00	22/11/22	FIRST ISSUE

**DRAWING STATUS**  
SUBMITTED AT DEADLINE 5

**PROJECT NUMBER**  
60589004

**SHEET TITLE**  
TREE PRESERVATION ORDER  
TREES LOCATION PLAN  
(SHEET 3)

**SHEET NUMBER**      **REV.**  
60589004-ACM-XX-XX-AB-TPOTLP-03      P01

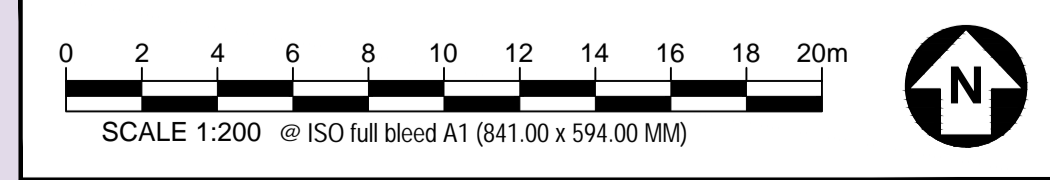

This drawing has been prepared for the use of AECOM's client. It may not be used, modified, reproduced or relied upon by third parties, except as agreed by AECOM or as required by law. AECOM accepts no responsibility and denies any liability whatsoever to any party that uses or relies on this drawing without AECOM's express written consent. Do not scale this document. All measurements must be obtained from the stated dimensions.